

Nutrifaster® N300

*N300 Juice Extractor,
Ideal for any kitchen !*

The Nutrifaster® N300 juicer is the most operator friendly juice extractor available on the market. The compact stainless steel design makes it ideal for low to medium juicing in health clubs, juice bars, restaurants, and households.

This juicer provides juice yields that will surpass or equal any juice extractor on the market today. The powerful, enclosed 1 HP motor and stainless steel juicing parts make it durable and easy to clean.

The Nutrifaster® N300 juicer is a leader in the health and nutritional field. Provide your customers with fresh juice, an intricate part of today's healthy lifestyle.

Maximize profits by serving fresh juice from your Nutrifaster® N300 Juicer!

- Easy to use and clean!
- Juices both fruits and vegetables!
- Immediate pulp ejection for non-stop juicing!
- Produces a glass of juice in seconds!
- Powerful **1.0 HP** motor!
- Heavy-duty construction for professional use!
- Patent Pending



COMMERCIAL and HOUSEHOLD JUICE EXTRACTOR

Juice Tree Co., 209 S. Bennett St., Seattle, WA 98108

1-800-800-2641 • 1-206-767-5054 • www.nutrifaster.com • sales@nutrifaster.com

Nutrifaster® N300

**INCREASE CUSTOMER SATISFACTION
BY SERVING FRESH NUTRIFASTER® N300 JUICE!**

MANUFACTURING JUICE EXTRACTORS FOR OVER 30 YEARS!

Compact, Powerful and Easy to clean.

Ideal for Commercial and Home use.

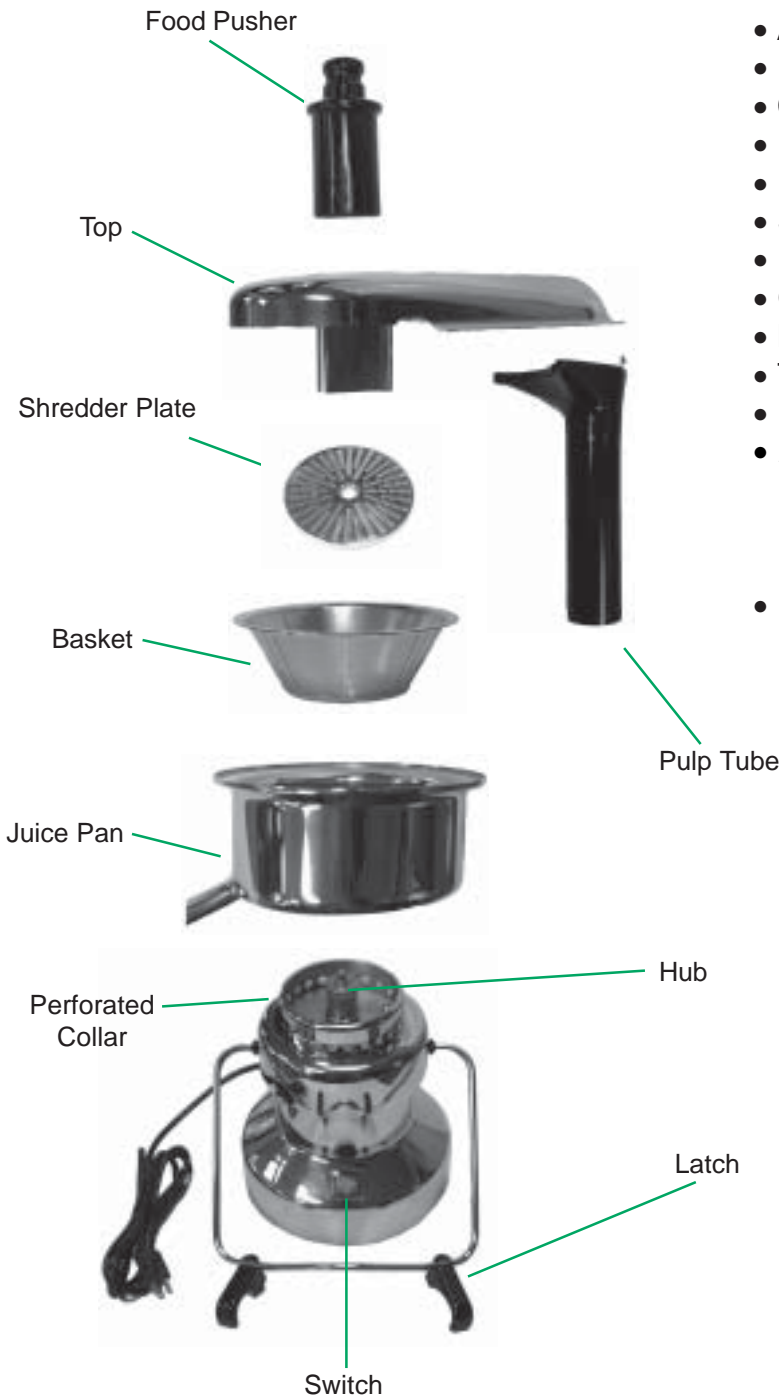

- All stainless steel construction
- Extremely Quiet During Operation
- Compact Countertop Design
- Produces a glass of juice in seconds
- Pulp Ejection Tube directs pulp below countertop
- Safety Interlock switch installed for operator safety
- Important Safeguards included in User's Manual
- One Year Limited Warranty
- Made in the USA by Nutrifaster, Inc.
- Toll Free Number for Sales and Service
- Personalized Customer Service
- *Listed to UL 763 Commercial, Listed to UL 982 Household, Listed to CSA Household / Commercial, Listed to NSF Std. 8, CE Approved*
- Patent Pending



MACHINE SPECIFICATIONS

New 1.0 HP Motor

3450 RPM

10.2 Amps

110 VOLTS/60 Hz

1056 WATTS

Stainless Steel Motor Shaft

Height: 16"

Diameter: 10"

Weight: 29 lbs.

220 V, 50Hz

configuration also available

Juice Tree Co., 209 S. Bennett St., Seattle, WA 98108

1-800-800-2641 • 1-206-767-5054 • www.nutrifaster.com • sales@nutrifaster.com